

# Water Heater Venting Catalog

## Configurations & Installations



**BOSCH**

Invented for life

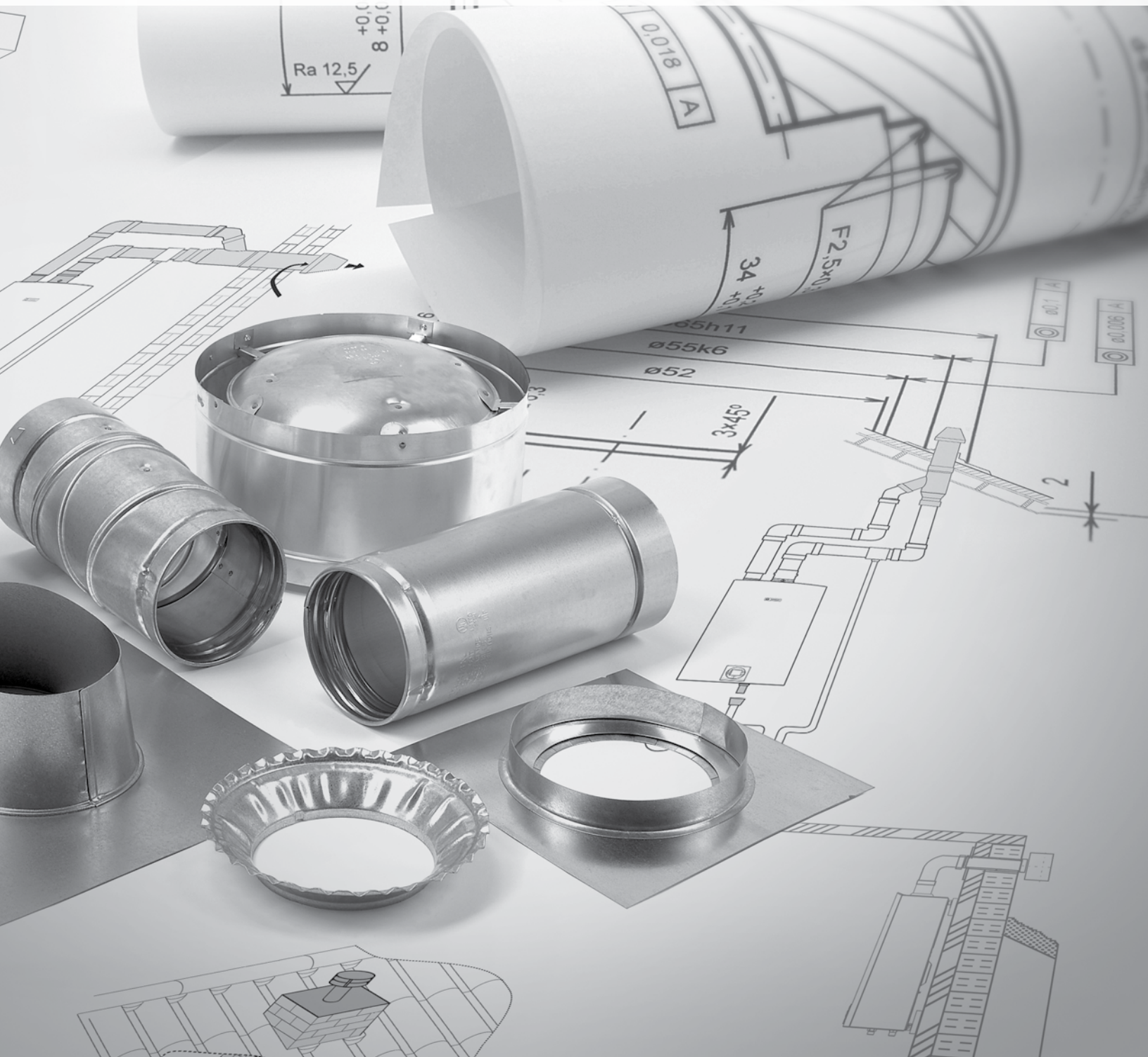

# About the Bosch Group



The Bosch Group has been a leading global supplier of technology and services in the areas of Automotive, Industrial Technology, Consumer Goods and Building Technology for 125 years. The company was founded in Stuttgart, Germany in 1886 and today has more than 300 subsidiaries in over 150 countries. Every Bosch product is built with one goal in mind; to enhance quality of life by providing innovative technological solutions. Bosch is highly regarded for its development of automotive braking and steering safety systems (ABS) which have been improving automotive performance for over 30 years, helping reduce the number of accidents on North America's roads and highways. Environmental stewardship inspires and drives Bosch product development. Bosch is a leader in the development of next-generation technologies that deliver improved performance and efficiency while conserving natural resources. In the area of sustainable mobility, we're helping reduce the fuel consumption and CO<sub>2</sub> emissions of new vehicles. Energy efficiency and environmental protection are also shaping our

Industrial Technology, Consumer Goods and Building Technology products. Green technologies, such as gas tankless water heaters, heat pump electric water heaters, solar thermal systems, photovoltaics, wind power and geothermal heat pumps are perhaps the best examples of smart technologies growing in demand and shaping the future of Bosch.

## **Bosch Thermotechnology in North America**

Bosch Thermotechnology is a leading source of high quality water heating and comfort heating systems. In particular, the company offers Bosch tankless, point-of-use water heaters, Bosch solar thermal systems, Bosch wall-hung boilers, Bosch geothermal heat pumps as well as controls and accessories for every product line.

As illustrated in this catalog and at [www.bosch-climate.us](http://www.bosch-climate.us), Bosch Thermotechnology is committed to reinventing energy efficiency by offering smart products that work together as integrated systems which enhance quality of life in an ultra-efficient and environmentally friendly manner.

Visit [www.bosch-climate.us](http://www.bosch-climate.us) to learn even more about Bosch's past, present and future.





# Contents

- 1** About the Bosch Group
- 3** **PVC venting installation configuration**
  - Condensing models
  - Concentric venting through wall
- 4** **PVC venting installation configuration**
  - Condensing models concentric
  - Concentric venting through roof
- 5** **Stainless steel venting installations**
  - Non-condensing models
  - Horizontal vent with room air intake
- 6** **Stainless steel venting installations**
  - Non-condensing models
  - Horizontal twin pipe termination
- 7** **Stainless steel venting installations**
  - Non-condensing models
  - Vertical twin pipe termination
- 8** **Stainless steel venting installations**
  - Non-condensing models
  - Concentric venting through wall
- 9** **Galvanized venting installations**
  - Non-condensing models
  - Horizontal through wall power vent option
- 10** **Galvanized venting installations**
  - Non-condensing models
  - Vertical configuration for unlined interior masonry chimney
- 11** **Stainless steel venting installations**
  - Non-condensing model 660 EF
  - Horizontal through wall
- 12** **Stainless steel venting installations**
  - Non-condensing model 660 EF
  - Vertical through roof
- 13** **Outdoor installations**
  - Outdoor venting kit
  - Recess box
- 14** Venting list (tear-out)
- 16** Bosch terms & conditions

# PVC venting installation configuration

Therm C 1210 ES/ESC, C 1050 ES & C 950 ES  
 Condensing models only

## Horizontal Concentric Venting Through Wall

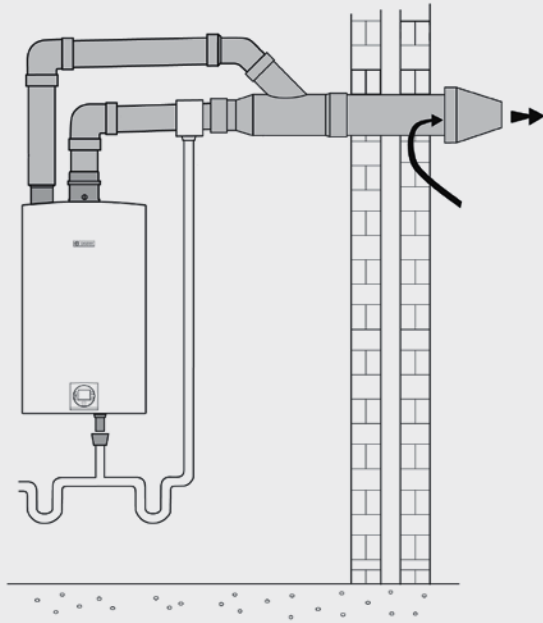

Vent Diameter	Maximum Exhaust Length	Elbow Length	
		45°	90°
3"	23'	3'	5'
4"	43' *	1.5'	2.5'

\* 23' if C 1210 ES/ESC

### Concentric Termination Kit - PVC

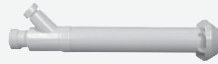

**Part Number** 196016  
**Description** Concentric Termination Kit - PVC  
**List Price** \$141.00

### Components Included in Kit:

**(1) Concentric Vent**  
 Not available for individual order

**(1) Condensate Drain Tee**  
**Part Number** 196061  
**Description** 3" x 1 1/2" S636 PVC Tee  
**List Price** \$14.00

**(1) Condensate Drain Tee Barb Fitting**  
**Part Number** 196278  
**Description** 1 1/2" x 1/2" S636 PVC Bushing x Barb Adapter  
**List Price** \$2.00

**(1) Stainless Steel Screw & Nut**  
 Not available for individual order

### Additional Components - Not Included in Kit:

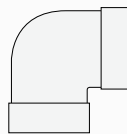

**Part Number** Available at your local Wholesaler  
**Description** (2) 90° PVC Elbows

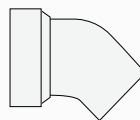

**Part Number** Available at your local Wholesaler  
**Description** (1) 45° PVC Elbow

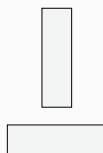

**Part Number** Available at your local Wholesaler  
**Description** 3" Straight PVC Pipe

# PVC venting installation configuration

Therm C 1210 ES/ESC, C 1050 ES & C 950 ES  
Condensing models only

## Vertical Concentric Venting Through Roof

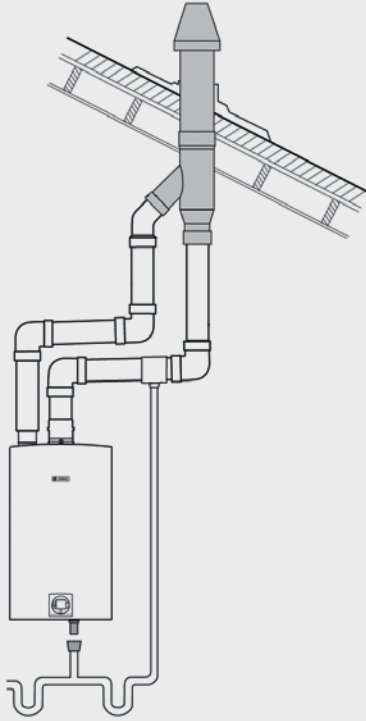

Vent Diameter	Maximum Exhaust Length	Elbow Length	
		45°	90°
3"	23'	3'	5'
4"	43' *	1.5'	2.5'

\* 23' if C 1210 ES/ESC

### Concentric Termination Kit - PVC

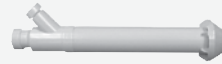

**Part Number** 196016  
**Description** Concentric Termination Kit - PVC  
**List Price** \$141.00

### Components Included in Kit:

**(1) Concentric Vent**  
Not available for individual order

**(1) Condensate Drain Tee**  
**Part Number** 196061  
**Description** 3" x 1 1/2" S636 PVC Tee  
**List Price** \$14.00

**(1) Condensate Drain Tee Barb Fitting**  
**Part Number** 196278  
**Description** 1 1/2" x 1/2" S636 PVC Bushing x Barb Adapter  
**List Price** \$2.00

**(1) Stainless Steel Screw & Nut**  
Not available for individual order

### Additional Components - Not Included in Kit:

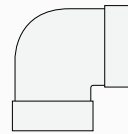

**Part Number** Available at your local Wholesaler  
**Description** (2) 90° PVC Elbows

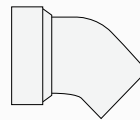

**Part Number** Available at your local Wholesaler  
**Description** (1) 45° PVC Elbow

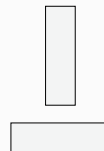

**Part Number** Available at your local Wholesaler  
**Description** 3" Straight PVC Pipe

# Stainless steel venting installations

Therm 940 ES & 830 ES

Non-condensing models only

## Horizontal Vent with Room Air Intake

### Minimum Vent Installation Side View

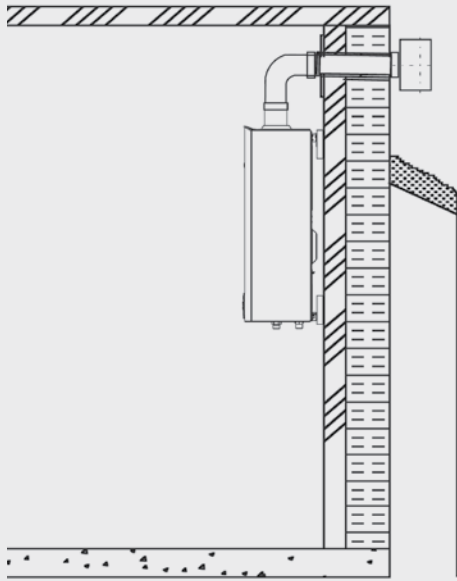

### Horizontal Vent Kit

SHOWN  
AT LEFT

**Part Number** 4TWHVK3SII  
**Description** Horizontal Vent Kit  
**List Price** \$287.00

### Components Included in Kit:

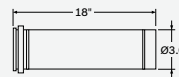

**Part Number** 7738000326  
**Description** (1) 3" x 18" Straight Pipe  
**List Price** \$43.00

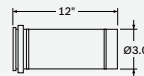

**Part Number** 7738000325  
**Description** (1) 3" x 12" Straight Pipe  
**List Price** \$27.00

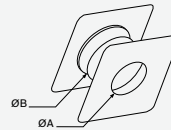

**Part Number** 2SVSWTCEC03  
**Description** (1) 3" Custom Wall Thimble  
**List Price** \$42.00

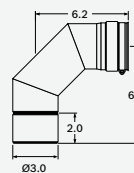

**Part Number** 7738000322  
**Description** (1) 3" x 90° Elbow  
**List Price** \$73.00

Vent Diameter	Maximum Exhaust Length	Elbow Length	
		45°	90°
3"	28.5'	1.25'	2.5'
4"	61.25'	0.75'	1.25'

### Other Stainless Steel Straight Pipes - Order as Needed:



**Part Number** 7738000324  
**Description** 3" x 6" Straight Pipe  
**List Price** \$22.00

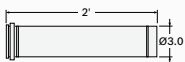

**Part Number** 7738000327  
**Description** 3" x 2' Straight Pipe  
**List Price** \$54.00

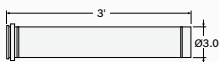

**Part Number** 7738000329  
**Description** 3" x 3' Straight Pipe  
**List Price** \$67.00

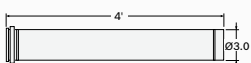

**Part Number** 7738000331  
**Description** 3" x 4' Straight Pipe  
**List Price** \$89.00

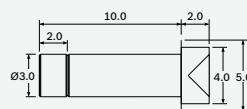

**Part Number** 2SVSFATRM03  
**Description** (1) 3" Intake Vent Termination w / 10" Sleeve  
**List Price** Not available for individual order

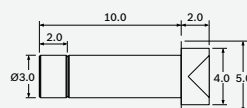

**Part Number** 2SVSTB03  
**Description** (1) 3" Exhaust Vent Termination w / 10" Sleeve  
**List Price** \$44.00

# Stainless steel venting installations

Therm 940 ES & 830 ES

Non-condensing models only

## Horizontal Twin Pipe Termination

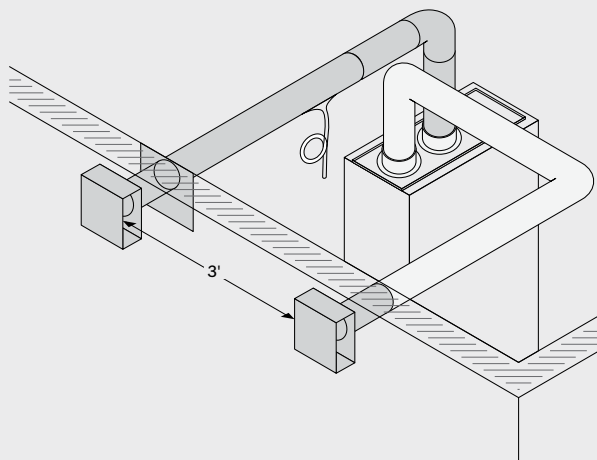

Vent Diameter	Maximum Exhaust Length	Elbow Length	
		45°	90°
3"	28.5'	1.25'	2.5'
4"	61.25'	0.75'	1.25'

### Horizontal Vent Kit

**SHOWN AT LEFT**

**Part Number** 4TWHVK3SII  
**Description** Horizontal Vent Kit  
**List Price** \$287.00

### Components Included in Kit:

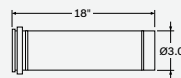

**Part Number** 7738000326  
**Description** (1) 3" x 18" Straight Pipe  
**List Price** \$43.00

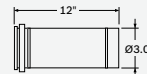

**Part Number** 7738000325  
**Description** (1) 3" x 12" Straight Pipe  
**List Price** \$27.00



**Part Number** 2SVSWTCEC03  
**Description** (1) 3" Custom Wall Thimble  
**List Price** \$42.00

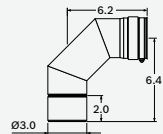

**Part Number** 7738000322  
**Description** (1) 3" x 90° Elbow  
**List Price** \$73.00

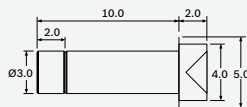

**Part Number** 2SVSFATRM03  
**Description** (1) 3" Intake Vent Termination w / 10" Sleeve  
**List Price** Not available for individual order

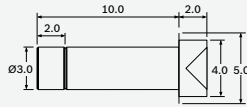

**Part Number** 2SVSTB03  
**Description** (1) 3" Exhaust Vent Termination w / 10" Sleeve  
**List Price** \$44.00

### Additional Intake Components - Not Included in Kit:

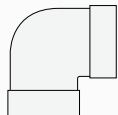

**Part Number** Available at your local Wholesaler  
**Description** (2) 90° PVC Elbows

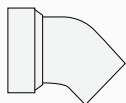

**Part Number** Available at your local Wholesaler  
**Description** (1) 45° PVC Elbow

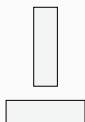

**Part Number** Available at your local Wholesaler  
**Description** 3" Straight PVC Pipe

### Other Stainless Steel Straight Pipes - Order as Needed:



**Part Number** 7738000324  
**Description** 3" x 6" Straight Pipe  
**List Price** \$22.00

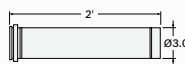

**Part Number** 7738000327  
**Description** 3" x 2' Straight Pipe  
**List Price** \$54.00

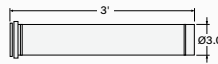

**Part Number** 7738000329  
**Description** 3" x 3' Straight Pipe  
**List Price** \$67.00

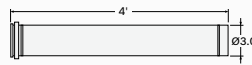

**Part Number** 7738000331  
**Description** 3" x 4' Straight Pipe  
**List Price** \$89.00

# Stainless steel venting installations

Therm 940 ES & 830 ES

Non-condensing models only

## Vertical Twin Pipe Termination

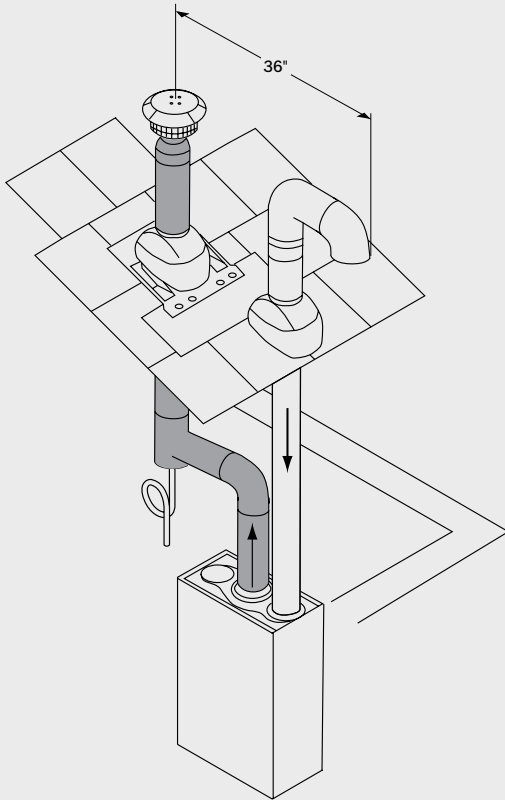

Vent Diameter	Maximum Exhaust Length	Elbow Length	
		45°	90°
3"	28.5'	1.25'	2.5'
4"	61.25'	0.75'	1.25'

### Additional Components - Not Included in Kit:

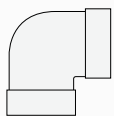

**Part Number** Available at your local Wholesaler  
**Description** (2) 90° PVC Elbows

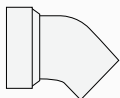

**Part Number** Available at your local Wholesaler  
**Description** (1) 45° PVC Elbow

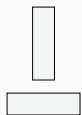

**Part Number** Available at your local Wholesaler  
**Description** 3" Straight PVC Pipe

### Vertical Vent Kit



**Part Number** 7738001131  
**Description** Vertical Vent Kit  
**List Price** \$294.00

### Components Included in Kit:

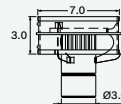

**Part Number** 2SVSHRC03  
**Description** (1) 3" Vertical Termination  
**List Price** \$87.00

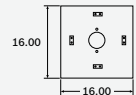

**Part Number** 2SVSFSSF03  
**Description** (1) 3" Firestop Support  
**List Price** \$49.00

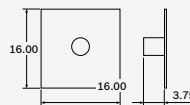

**Part Number** 2SVSADJF03  
**Description** (1) 3" Roof Flashing  
 0/12 - 6/12  
**List Price** \$60.00

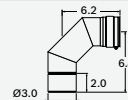

**Part Number** 7738000322  
**Description** (1) 3" x 90° Elbow  
**List Price** \$73.00

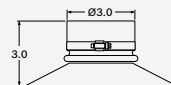

**Part Number** 2SVSLSF03  
**Description** (1) 3" Storm Collar  
**List Price** \$27.00

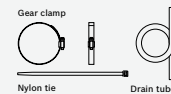

**Part Number** 2SVEDTK24  
**Description** (1) 24" Drain Tube Kit  
**List Price** \$24.00

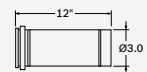

**Part Number** 7738000325  
**Description** (1) 3" x 12" Straight Pipe  
**List Price** \$27.00

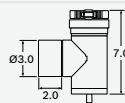

**Part Number** 2SVEVWCF03  
**Description** (1) 3" Vertical Drain Tee  
**List Price** \$67.00

### Other Stainless Steel Straight Pipes - Order as Needed:



**Part Number** 7738000324  
**Description** 3" x 6" Straight Pipe  
**List Price** \$22.00

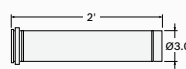

**Part Number** 7738000327  
**Description** 3" x 2" Straight Pipe  
**List Price** \$54.00

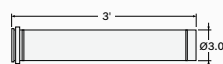

**Part Number** 7738000329  
**Description** 3" x 3" Straight Pipe  
**List Price** \$67.00

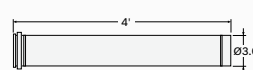

**Part Number** 7738000331  
**Description** 3" x 4" Straight Pipe  
**List Price** \$89.00

# Stainless steel venting installations

Therm 940 ES & 830 ES

Non-condensing models only

## Concentric Venting Through Wall

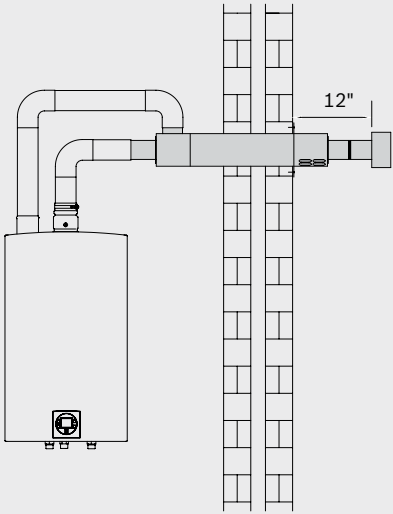

### Horizontal Concentric Vent Kit

SHOWN AT LEFT

<b>Part Number</b>	THERMHCK
<b>Description</b>	Therm Concentric Vent Kit Stainless Steel
<b>List Price</b>	\$260.00

### Components Included in Kit:

<b>Part Number</b>	ESHCK
<b>Description</b>	Concentric Vent Termination
<b>List Price</b>	\$151.00

**(1) Concentric Sleeve / Exterior Wall**  
Not available for individual order

**(1) Intake Pipe Connector**  
Not available for individual order

**(1) Bag of Screws**  
Not available for individual order

Vent Diameter	Maximum Exhaust Length	Elbow Length	
		45°	90°
3"	28.5'	1.25'	2.5'
4"	61.25'	0.75'	1.25'

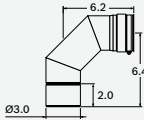

<b>Part Number</b>	7738000322
<b>Description</b>	(1) 3" x 90° Elbow
<b>List Price</b>	\$73.00

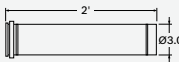

<b>Part Number</b>	7738000327
<b>Description</b>	(1) 3" x 2' Straight Pipe
<b>List Price</b>	\$54.00

### Additional Components - Not Included in Kit:

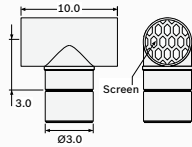

<b>Part Number</b>	2SVSTTF03
<b>Description</b>	(1) 3" Termination Tee
<b>List Price</b>	\$52.00

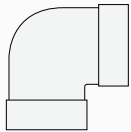

<b>Part Number</b>	Available at your local Wholesaler
<b>Description</b>	3" x 90° PVC Elbows (as needed)

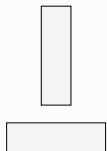

<b>Part Number</b>	Available at your local Wholesaler
<b>Description</b>	3" Straight PVC Pipe (as needed)

### Other Stainless Steel Straight Pipes - Order as Needed:



<b>Part Number</b>	7738000324
<b>Description</b>	3" x 6" Straight Pipe
<b>List Price</b>	\$22.00

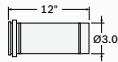

<b>Part Number</b>	7738000325
<b>Description</b>	3" x 12" Straight Pipe
<b>List Price</b>	\$27.00

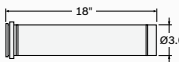

<b>Part Number</b>	7738000326
<b>Description</b>	3" x 18" Straight Pipe
<b>List Price</b>	\$43.00

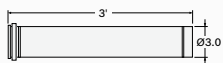

<b>Part Number</b>	7738000329
<b>Description</b>	3" x 3' Straight Pipe
<b>List Price</b>	\$67.00

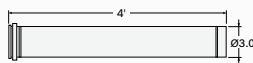

<b>Part Number</b>	7738000331
<b>Description</b>	3" x 4' Straight Pipe
<b>List Price</b>	\$89.00

# Galvanized venting installations

Therm 520 HN/PN

Non-condensing models only

## Horizontal Through Wall Power Vent Option

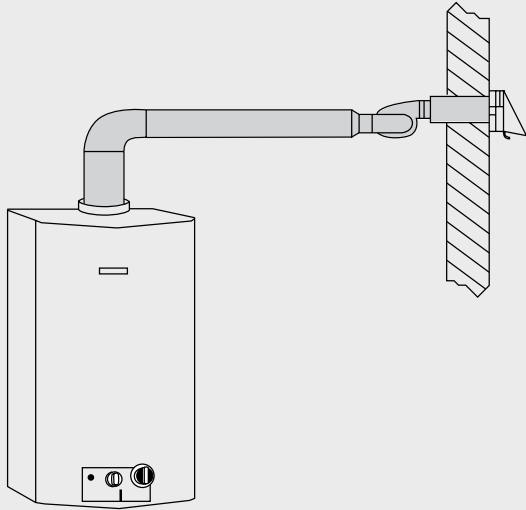

### Power Vent w/Back Draft Flapper Kit

**Part Number** AQ4  
**Description** Power Vent w/  
Back Draft Flapper  
**List Price** \$433.00



Vent Diameter	Maximum Exhaust Length	Elbow Length	
		45°	90°
3"	28.5'	1.25'	2.5'
4"	61.25'	0.75'	1.25'

### Components Included in Kit:

**4" Vent Hood**  
Not available for individual order

**5" to 4" Reducer Pipe**  
Not available for individual order

**Flow Switch**  
Not available for individual order

**Power Vent Motor**  
Not available for individual order

### Additional Components - Not Included in Kit:

**NO IMAGE AVAILABLE**      **Part Number** Available at your local Wholesaler  
**Description** 5" Galvanized B-Vent Straight Pipe (length as needed)

**NO IMAGE AVAILABLE**      **Part Number** Available at your local Wholesaler  
**Description** 5" Galvanized B-Vent 90° Elbow (as needed)

# Galvanized venting installations

Therm 520 HN / PN

Non-condensing models only

## Vertical Configuration for Unlined Interior Masonry Chimney

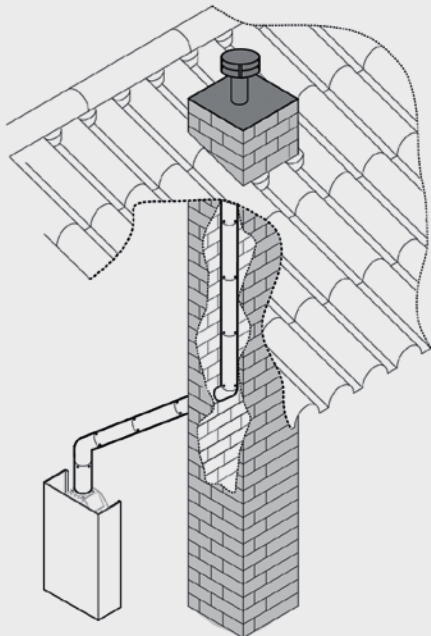
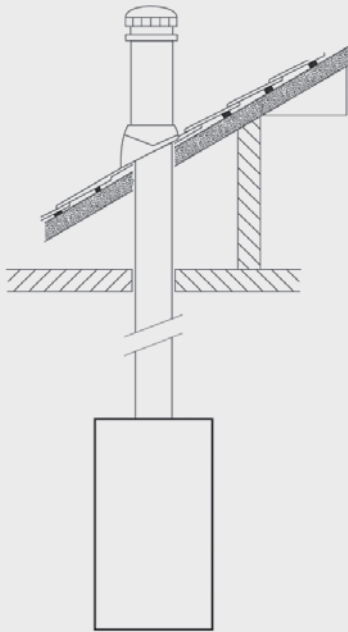

### Vertical Vent Kit

<b>Part Number</b>	7738000030
<b>Description</b>	Vertical Vent Kit for Therm
<b>List Price</b>	\$114.00



### Components Included in Kit:

<b>(1) Rain Cap</b>	Not available for individual order
<b>(1) Storm Collar</b>	Not available for individual order
<b>(1) Roof Flashing</b>	Not available for individual order
<b>(1) Fire Stop</b>	Not available for individual order
<b>(1) 5" x 12" Straight Pipe</b>	Not available for individual order
<b>(2) 5" x 90° Elbows</b>	Not available for individual order

### Additional Components - Not Included in Kit:

<b>NO IMAGE AVAILABLE</b>	<b>Part Number</b>	Available at your local Wholesaler
	<b>Description</b>	5" Galvanized B-Vent Straight Pipe (length as needed)
<b>NO IMAGE AVAILABLE</b>	<b>Part Number</b>	Available at your local Wholesaler
	<b>Description</b>	5" Galvanized B-Vent 90° Elbow (as needed)
<b>NO IMAGE AVAILABLE</b>	<b>Part Number</b>	Available at your local Wholesaler
	<b>Description</b>	5" Galvanized B-Vent 45° Elbow (as needed)

# Stainless steel venting installations

Therm 660 EF

Non-condensing models only

## Horizontal Through Wall

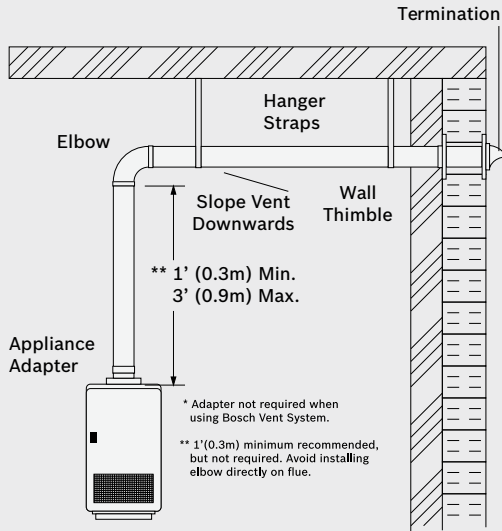

\* Adapter not required when using Bosch Vent System.  
 \*\* 1'(0.3m) minimum recommended, but not required. Avoid installing elbow directly on flue.

Vent Diameter	Maximum Exhaust Length	Elbow Length
3"	35'	90° 10'

### Horizontal Kit Termination

<b>SHOWN AT LEFT</b>	<b>Part Number</b> 7709003953	<b>Description</b> Horizontal Kit Termination (6")	<b>List Price</b> \$281.00
<b>SHOWN AT LEFT</b>	<b>Part Number</b> 7709003954	<b>Description</b> Horizontal Kit Termination (9")	<b>List Price</b> \$281.00

### Components Included in (6") Kit:

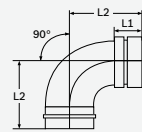

<b>Part Number</b> 7709003941	<b>Description</b> 90° Elbow Vent Pipe	<b>List Price</b> \$57.00
-------------------------------	--	---------------------------

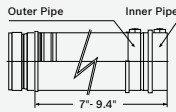

<b>Part Number</b> 7709003936	<b>Description</b> 7" - 9.4" Adjustable Vent Pipe	<b>List Price</b> \$47.00
-------------------------------	---	---------------------------

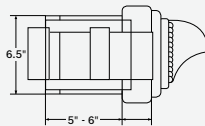

<b>* Part Number</b> 7738000828	<b>Description</b> Adjustable Wall Thimble w/Built-In Hood Termination (5" - 6")	<b>List Price</b> \$170.00
---------------------------------	--	----------------------------

### Additional Components - Not Included in Kit:

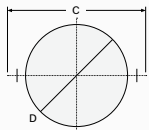

<b>Part Number</b> 7709003926	<b>Description</b> 3" Support Clamp (Qty 1 = 5 Sets)	<b>List Price</b> \$6.00
-------------------------------	--	--------------------------

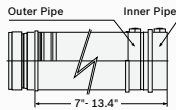

<b>Part Number</b> 7709003937	<b>Description</b> 9" - 13.4" Adjustable Vent Pipe	<b>List Price</b> \$55.00
-------------------------------	--	---------------------------

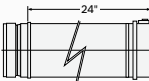

<b>Part Number</b> 7709003933	<b>Description</b> 24" Straight Vent Pipe	<b>List Price</b> \$42.00
-------------------------------	---	---------------------------

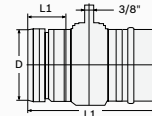

<b>Part Number</b> 7709003920	<b>Description</b> Drip Tee Horizontal Condensation Drain	<b>List Price</b> \$25.00
-------------------------------	---	---------------------------

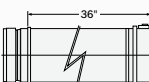

<b>Part Number</b> 7709003934	<b>Description</b> 36" Straight Vent Pipe	<b>List Price</b> \$52.00
-------------------------------	---	---------------------------

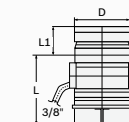

<b>Part Number</b> 7709003921	<b>Description</b> Drip Tee Vertical Condensation Drain	<b>List Price</b> \$41.00
-------------------------------	---	---------------------------

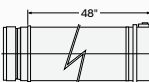

<b>Part Number</b> 7709003935	<b>Description</b> 48" Straight Vent Pipe	<b>List Price</b> \$69.00
-------------------------------	---	---------------------------

\*For 9" Kit, use Part Number 7709009950

# Stainless steel venting installations

Therm 660 EF

Non-condensing models only

## Vertical Through Roof

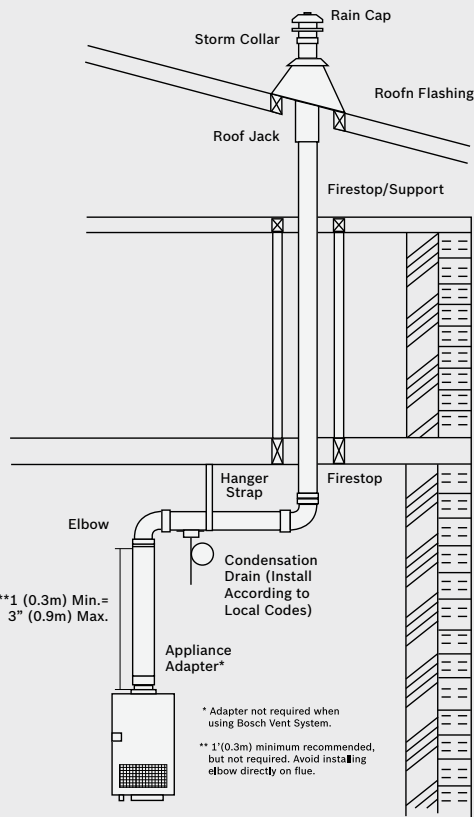

### Vertical Kit Termination

SHOWN AT LEFT

<b>Part Number</b>	7709003955
<b>Description</b>	Vertical Kit Termination
<b>List Price</b>	\$437.00

### Components Included in Kit:

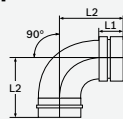

<b>Part Number</b>	7709003941
<b>Description</b>	90° Elbow Vent Pipe
<b>List Price</b>	\$57.00

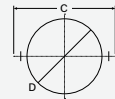

<b>Part Number</b>	7709003926
<b>Description</b>	3" Support Clamp (Qty 1 = 5 Sets)
<b>List Price</b>	\$6.00

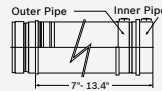

<b>Part Number</b>	7709003937
<b>Description</b>	9" - 13.4" Adjustable Vent Pipe
<b>List Price</b>	\$55.00

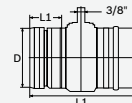

<b>Part Number</b>	7709003920
<b>Description</b>	Drip Tee Horizontal Condensation Drain
<b>List Price</b>	\$25.00

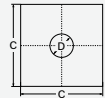

<b>Part Number</b>	7709003922
<b>Description</b>	Vertical Firestop
<b>List Price</b>	\$32.00

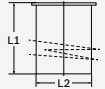

<b>Part Number</b>	7709003924
<b>Description</b>	Roof Jack
<b>List Price</b>	\$47.00

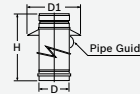

<b>Part Number</b>	7709003925
<b>Description</b>	3" Storm Collar Ring
<b>List Price</b>	\$33.00

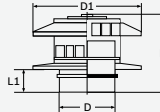

<b>Part Number</b>	7709003947
<b>Description</b>	Rain Cap Vertical Vent Termination
<b>List Price</b>	\$68.00

Vent Diameter	Maximum Exhaust Length	Elbow Length
3"	35'	90° 10'

### Additional Components - Not Included in Kit:

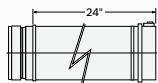

<b>Part Number</b>	7709003933
<b>Description</b>	24" Straight Vent Pipe
<b>List Price</b>	\$42.00

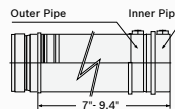

<b>Part Number</b>	7709003936
<b>Description</b>	7" - 9.4" Adjustable Vent Pipe
<b>List Price</b>	\$47.00

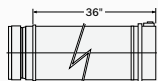

<b>Part Number</b>	7709003934
<b>Description</b>	36" Straight Vent Pipe
<b>List Price</b>	\$52.00

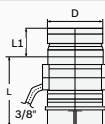

<b>Part Number</b>	7709003921
<b>Description</b>	Drip Tee Vertical Condensation Drain
<b>List Price</b>	\$41.00



<b>Part Number</b>	7709003935
<b>Description</b>	48" Straight Vent Pipe
<b>List Price</b>	\$69.00

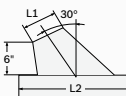

<b>Part Number</b>	7709003923
<b>Description</b>	Angled Roof Flashing
<b>List Price</b>	\$53.00

# Outdoor installations

Therm C 1210 ES/ESC, C 1050 ES,  
C 950 ES, 940 ES, 830 ES & 660 EFO

## Outdoor Venting Kit

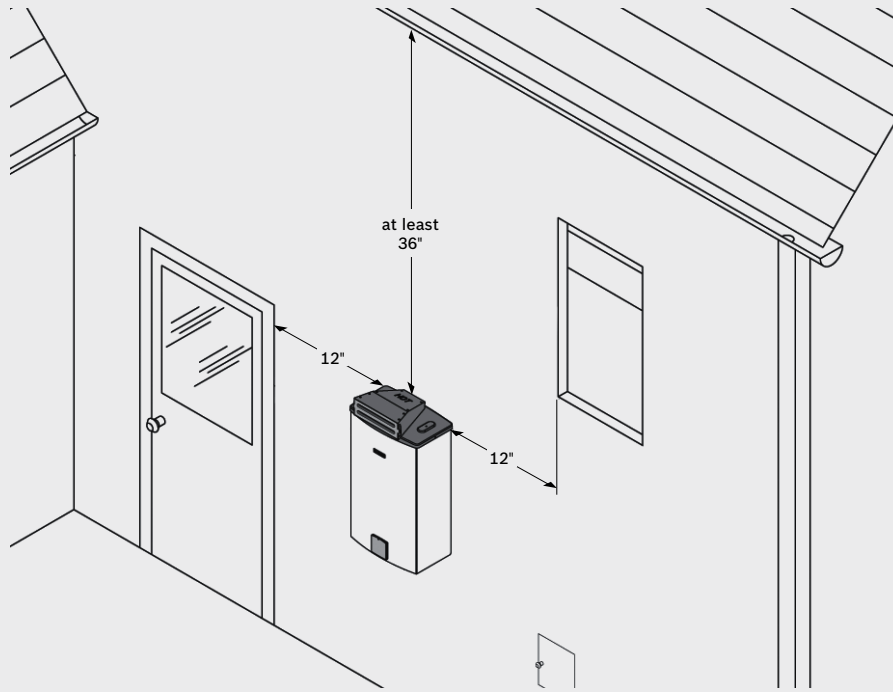

### Outdoor Kit for Therm

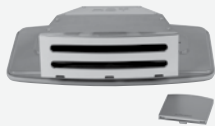

**Part Number** 7709003913  
**Description** Outdoor Kit for Therm 830 ES to C 1210 ES Models  
**List Price** \$115.00

### Additional Components - Not Included in Kit:

Requires Purchase of Outdoor Kit



**Part Number** 7736500043  
**Description** Recess Box for Therm 830 ES to C 1210 ES Models  
**List Price** \$220.00

**Part Number** 7709003957  
**Description** Recess Box for Therm 660 EFO Model  
**List Price** \$190.00

# Venting list

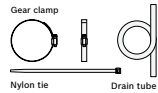

**Part Number** 2SVEDTK24  
**Description** 24" Drain Tube Kit  
**List Price** \$24.00

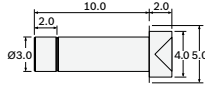

**Part Number** 2SVSTB03  
**Description** 3" Exhaust/Intake Vent Termination w/10" Sleeve (Qty 2)  
**List Price** \$44.00

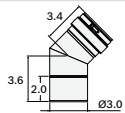

**Part Number** 7738000320  
**Description** 3" x 45° Elbow  
**List Price** \$65.00

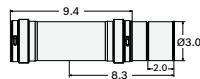

**Part Number** 4ZVAL03  
**Description** 3" Adjustable Adapter  
**List Price** \$98.00

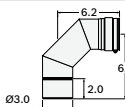

**Part Number** 7738000322  
**Description** 3" x 90° Elbow  
**List Price** \$73.00

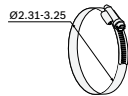

**Part Number** 7HS44XX  
**Description** 3" Gear Clamps (Qty 2)  
**List Price** \$4.00



**Part Number** 7738000324  
**Description** 3" x 6" Straight Pipe  
**List Price** \$22.00

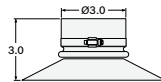

**Part Number** 2SVSLSF03  
**Description** 3" Storm Collar  
**List Price** \$27.00



**Part Number** 7738000325  
**Description** 3" x 12" Straight Pipe  
**List Price** \$27.00

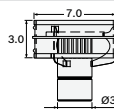

**Part Number** 2SVSHRC03  
**Description** (1) 3" Vertical Termination  
**List Price** \$87.00

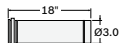

**Part Number** 7738000326  
**Description** 3" x 18" Straight Pipe  
**List Price** \$43.00

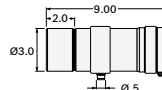

**Part Number** 2SVEDWCF03  
**Description** Horizontal Drain Tee  
**List Price** \$52.00

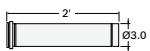

**Part Number** 7738000327  
**Description** 3" x 2" Straight Pipe  
**List Price** \$54.00

**NO IMAGE AVAILABLE**

**Part Number** 4TWHVK3SII  
**Description** Horizontal Vent Kit  
**List Price** \$287.00

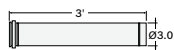

**Part Number** 7738000329  
**Description** 3" x 3" Straight Pipe  
**List Price** \$67.00

**NO IMAGE AVAILABLE**

**Part Number** 2SVSTB03  
**Description** 3" Exhaust Vent Termination w/ 10" Sleeve  
**List Price** \$44.00

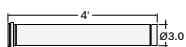

**Part Number** 7738000331  
**Description** 3" x 4" Straight Pipe  
**List Price** \$89.00

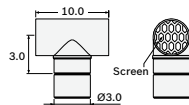

**Part Number** 2SVSTTF03  
**Description** 3" Vertical Termination Tee  
**List Price** \$52.00

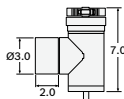

**Part Number** 2SVEVWCF03  
**Description** 3" Vertical Drain Tee  
**List Price** \$67.00



**Part Number** 7738001131  
**Description** Vertical Vent Kit  
**List Price** \$294.00

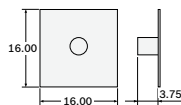

**Part Number** 2SVSADJF03  
**Description** 3" Roof Flashing 0/12 - 6/12  
**List Price** \$60.00

**NO IMAGE AVAILABLE**

**Part Number** THERMHCK  
**Description** Therm Concentric Vent Kit Stainless Steel  
**List Price** \$260.00

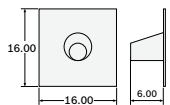

**Part Number** 2SVSADJSF03  
**Description** 3" Roof Flashing 7/12-12/12  
**List Price** \$61.00



**Part Number** AQ4  
**Description** Power Vent w/Back Draft Flapper  
**List Price** \$433.00

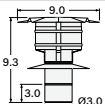

**Part Number** 2SVSRCF03  
**Description** 3" Rain Cap  
**List Price** \$87.00



**Part Number** 7738000030  
**Description** Vertical Vent Kit for Therm 520 HN / PN Models  
**List Price** \$114.00







**Part Number** 2SVSWTCEC03  
**Description** 3" Custom Wall Thimble  
**List Price** \$42.00

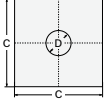
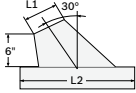
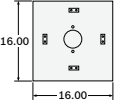
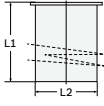
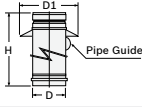
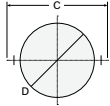
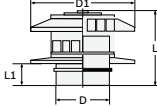
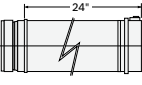
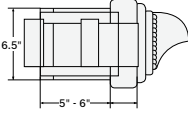
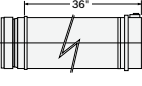

**Part Number** 7709003913  
**Description** Outdoor Kit for Therm 830 ES to C 1210 ES Models  
**List Price** \$115.00

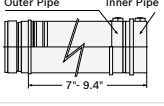
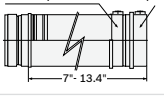
# Venting list

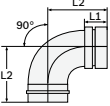
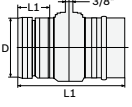
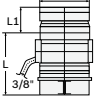
	<p><b>Part Number</b> 7709003957  <b>Description</b> Recess Box for Therm 660 EFO  <b>List Price</b> \$190.00</p>		<p><b>Part Number</b> 7709003922  <b>Description</b> Vertical Firestop for Therm 660 EF  <b>List Price</b> \$32.00</p>
	<p><b>Part Number</b> 7736500043  <b>Description</b> Recess Box for Therm 830 ES to C 1210 ES  <b>List Price</b> \$220.00</p>		<p><b>Part Number</b> 7709003923  <b>Description</b> Angled Roof Flashing for Therm 660 EF  <b>List Price</b> \$53.00</p>
	<p><b>Part Number</b> 2SVSFSS03  <b>Description</b> 3" Firestop Support  <b>List Price</b> \$49.00</p>		<p><b>Part Number</b> 7709003924  <b>Description</b> Roof Jack for Therm 660 EF  <b>List Price</b> \$47.00</p>
<b>NO IMAGE AVAILABLE</b>	<p><b>Part Number</b> 2SVSWB03  <b>Description</b> 3" Vent Adaptor for Therm 660 EF  <b>List Price</b> \$23.00</p>		<p><b>Part Number</b> 7709003925  <b>Description</b> 3" Storm Collar Ring for Therm 660 EF  <b>List Price</b> \$33.00</p>
	<p><b>Part Number</b> 7709003926  <b>Description</b> 3" Support Clamp (Qty 1 = 5 Sets)  <b>List Price</b> \$6.00</p>		<p><b>Part Number</b> 7709003947  <b>Description</b> Rain Cap Vertical Vent Termination for Therm 660 EF  <b>List Price</b> \$68.00</p>
	<p><b>Part Number</b> 7709003933  <b>Description</b> 24" Straight Vent Pipe for Therm 660 EF  <b>List Price</b> \$42.00</p>		<p><b>Part Number</b> 7738000828  <b>Description</b> Adjustable Wall Thimble w/Built-In Hood Termination (5" - 6") for Therm 660 EF  <b>List Price</b> \$170.00</p>
	<p><b>Part Number</b> 7709003934  <b>Description</b> 36" Straight Vent Pipe for Therm 660 EF  <b>List Price</b> \$52.00</p>	<b>NO IMAGE AVAILABLE</b>	<p><b>Part Number</b> 7709003953  <b>Description</b> Horizontal Kit Termination (6") for Therm 660 EF  <b>List Price</b> \$281.00</p>
	<p><b>Part Number</b> 7709003935  <b>Description</b> 48" Straight Vent Pipe for Therm 660 EF  <b>List Price</b> \$69.00</p>	<b>NO IMAGE AVAILABLE</b>	<p><b>Part Number</b> 7709003954  <b>Description</b> Horizontal Kit Termination (9") for Therm 660 EF  <b>List Price</b> \$281.00</p>
	<p><b>Part Number</b> 7709003936  <b>Description</b> 7" - 9.4" Adjustable Vent Pipe for Therm 660 EF  <b>List Price</b> \$47.00</p>	<b>NO IMAGE AVAILABLE</b>	<p><b>Part Number</b> ESHCK  <b>Description</b> Concentric Vent Termination  <b>List Price</b> \$151.00</p>
	<p><b>Part Number</b> 7709003937  <b>Description</b> 9" - 13.4" Adjustable Vent Pipe for Therm 660 EF  <b>List Price</b> \$55.00</p>		<p><b>Part Number</b> 196016  <b>Description</b> Concentric Termination Kit- PVC  <b>List Price</b> \$141.00</p>
<b>NO IMAGE AVAILABLE</b>	<p><b>Part Number</b> 7709003955  <b>Description</b> Vertical Kit Termination for Therm 660 EF  <b>List Price</b> \$437.00</p>	<b>NO IMAGE AVAILABLE</b>	<p><b>Part Number</b> L2594  <b>Description</b> Exhaust/Intake Bird Screen - PVC  <b>List Price</b> \$4.00</p>
	<p><b>Part Number</b> 7709003941  <b>Description</b> 90° Elbow Vent Pipe for Therm 660 EF  <b>List Price</b> \$57.00</p>	<b>NO IMAGE AVAILABLE</b>	<p><b>Part Number</b> 196061  <b>Description</b> 3" x 1 1/2" S636 PVC Tee  <b>List Price</b> \$14.00</p>
	<p><b>Part Number</b> 7709003920  <b>Description</b> Drip Tee Horizontal Condensation Drain for Therm 660 EF  <b>List Price</b> \$25.00</p>	<b>NO IMAGE AVAILABLE</b>	<p><b>Part Number</b> 196278  <b>Description</b> 1 1/2" x 1/2" S636 PVC Bushing x Barb Adapter  <b>List Price</b> \$2.00</p>
	<p><b>Part Number</b> 7709003921  <b>Description</b> Drip Tee Vertical Condensation Drain for Therm 660 EF  <b>List Price</b> \$41.00</p>		

# Bosch Thermotechnology Corp.

## Terms & conditions of sale

Portions of Bosch Thermotechnology Corp. Terms and Conditions of Sale can be found below. Please refer to our website: [www.boschthermotechnology.com](http://www.boschthermotechnology.com) for complete Terms and Conditions of Sale.

### 1. GENERAL

1.1 Your purchase order(s), when accepted, will be subject to the Terms and Conditions of Sale found on [www.boschthermotechnology.com](http://www.boschthermotechnology.com). The terms and conditions referenced on [www.boschthermotechnology.com](http://www.boschthermotechnology.com) constitute the entire agreement between you ("Buyer") and Bosch Thermotechnology Corp. ("BTC") with respect to the transaction(s) covered by your purchase order(s) as confirmed by BTC.

1.2 No modification or waiver of any of the terms and conditions found on [www.boschthermotechnology.com](http://www.boschthermotechnology.com) and no additional or different terms or conditions shall be effective unless (i) modified by BTC's quotation or sales modified by BTC's quotation or sales acknowledgement, or (ii) agreed to in a single writing signed by both parties. No oral agreement, course of performance or other means other than such written agreement signed by both parties expressly providing for such waiver shall be deemed to waive the terms of this document.

### 2. PRICES AND TAXES

2.1 All prices are based upon BTC's pricing in effect on the date of the quotation, unless otherwise indicated on the face of the quotation. The delivery date will be established on the order acknowledgement form prepared and sent by BTC. BTC reserves the right to adjust the prices due to increases in material, labor, manufacturing or shipping costs if the increases occur before the delivery date. If the amount of the cost increases exceed ten (10) percent, BTC has the right to cancel the contract on four (4) weeks notice in writing, and the delivery will not be made unless a new price agreement is reached.

2.2 The Prices do not include any applicable Federal, State or local sales, use, excise, value-added or similar-

type tax or assessments applicable to the price, sale, use or delivery of the Goods ordered by Buyer. Such taxes and assessments will be included in BTC's invoice and paid by Buyer unless Buyer's purchase order plainly states on its face the existence of an exemption from any such tax or assessment and Buyer provides BTC with evidence of such exemption from the applicable taxing authority.

### 5. WARRANTY POLICY \*

5.1 Unless a different limited written warranty is provided by BTC with the Goods, the terms and conditions of the warranty for the Goods shall be subject to the following limited written warranty. BTC warrants all Goods manufactured by it to be free from defects in material and workmanship for one year from the following:

- 5.1.1 The date of installation if a warranty card has been received by BTC that sets forth the correct date of installation;
- 5.1.2 The date of purchase if the date can be established by an invoice; or
- 5.1.3 The date of manufacture if the information required in 5.1.1 or 5.1.2 is not available.

Buyer's sole and exclusive remedy under this warranty shall be limited to either the repair or exchange of warranted products, at BTC's option FCA BTC's factory. No attempt to repair or improve the Goods or parts by any of BTC's representatives shall change or extend this warranty.

#### 5.2 Limitations on Warranty

**THE FOREGOING WARRANTY IS EXPRESSLY IN LIEU OF ANY OTHER WARRANTIES, EXPRESSED OR IMPLIED, INCLUDING BUT NOT LIMITED TO THE IMPLIED WARRANTIES OF MERCHANTABILITY OR FITNESS FOR A PARTICULAR PURPOSE.**

The above warranty does not apply to specialty items or modifications to Goods, which as detailed in section 12.2 of Terms and Conditions of Sale found on [www.boschthermotechnology.com](http://www.boschthermotechnology.com), are purchased "AS IS".





**Bosch Thermotechnology Corp.**

Londonderry, NH • Ft. Lauderdale, FL • Irvine, CA

General Inquiries: 1-866-642-3198

Technical Support: 1-866-446-8987

**[www.bosch-climate.us](http://www.bosch-climate.us)**

Printed on Elemental Chlorine Free, FSC-certified,  
minimum 10% PCW paper with vegetable-based inks.  
Copyright © 2011 Bosch Thermotechnology Corp. All rights reserved.

