

# Technical service bulletin

## Heat Exchanger Replacement

# Buderus

### Heat Exchanger Replacement Procedure

- Remove the cable plug from the gas control valve.

Figure 1

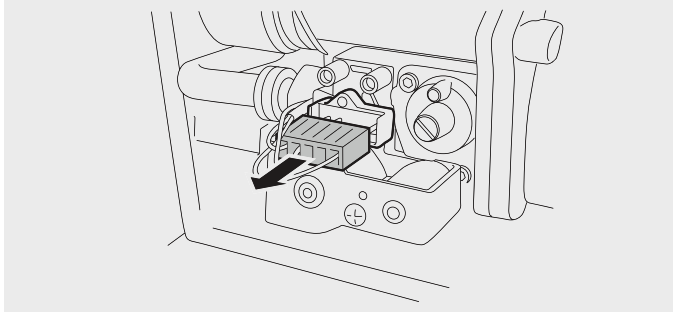

- Remove both cable plugs [Fig.2, pos.1] from the fan unit.

Figure 2

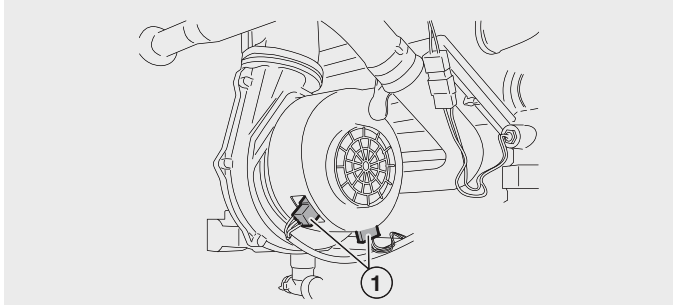

- Pull down on both retaining clips [Fig.3, pos.1] to open and remove the burner cover.

Figure 3

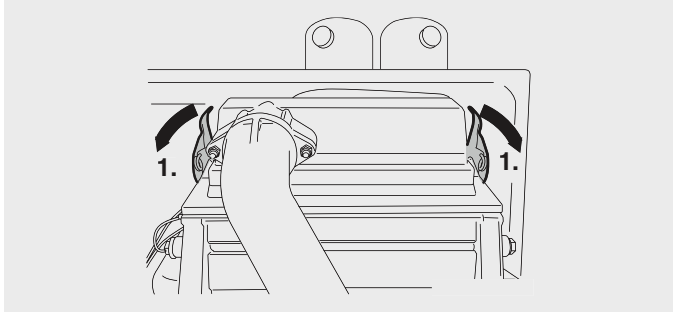

- Remove the burner [Fig.4, pos.1].

Figure 4

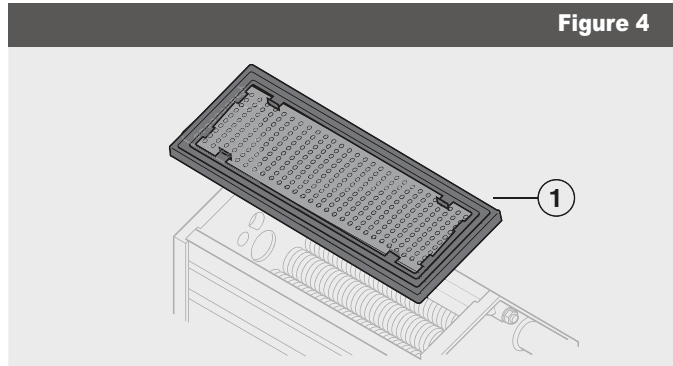

- Disconnect the supply [Fig.5, pos.1] and return [Fig.5, pos.2] sensors.



#### CAUTION: electrical short circuit

To prevent mix-ups, the supply sensor is marked by a red sleeve on the side of the cable harness.

Figure 5

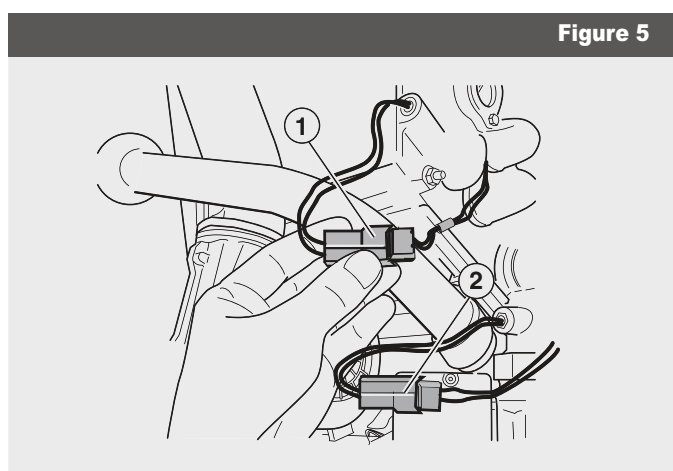

- Disconnect the safety sensor [Fig.6, pos.1].

Figure 6

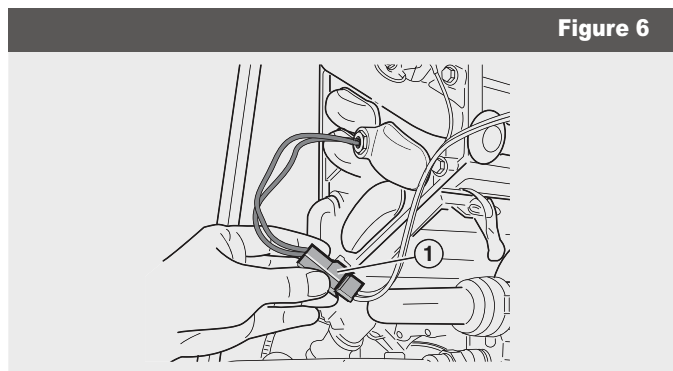

- ▶ Disconnect the hot surface ignitor and ionization electrode plugs.
- ▶ Loosen the fastening screws [Fig.7, pos.1].
- ▶ Pull the ground cable from the hot surface ignitor [Fig.7, pos.2].
- ▶ Dismantle the mounting plate [Fig.7, pos.3].

Figure 7

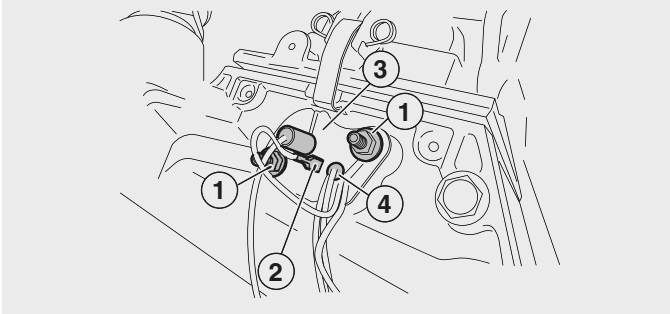

- ▶ Remove both the hot surface ignitor and the ionization electrode from heat exchanger [Fig.8].

Figure 8

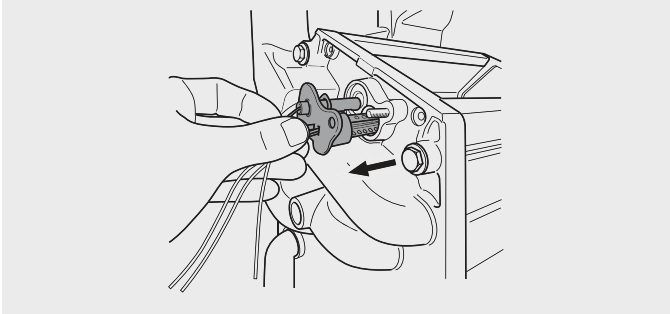

- ▶ Open latches [Fig.9, pos.1] on the condensate collector.

Figure 9

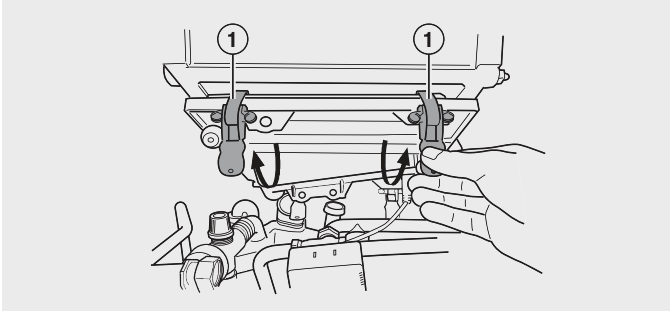

- ▶ Remove the condensate collector.

- ▶ Dismantle the tension spring [Fig.10, pos.1] between the supply pipe and the heat exchanger.
- ▶ Fully loosen nut [Fig.10, pos.2]. Remove both the nut and the clip that was revealed beneath it from the old heat exchanger and reinstall them on to the replacement heat exchanger in the same location.

Figure 10

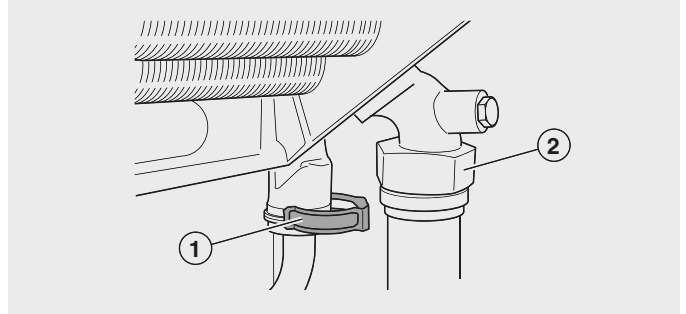

- ▶ Loosen with one turn the nut [Fig.11, pos.1] between the supply
- ▶ Pull the supply pipe [Fig.11, pos.2] out of the heat exchanger.

Figure 11

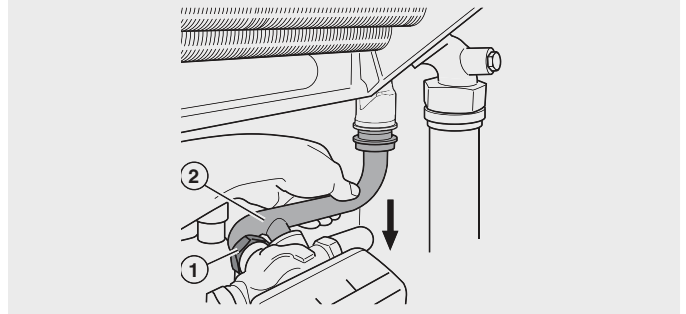

- ▶ Pull the combustion air supply and flue gas exhaust connections on top of the appliance upwards to remove them.
- ▶ Loosen all fastening screws of the flue gas adapter.
- ▶ Remove the flue gas adapter [Fig.12, pos.1] from the top of the appliance.

Figure 12

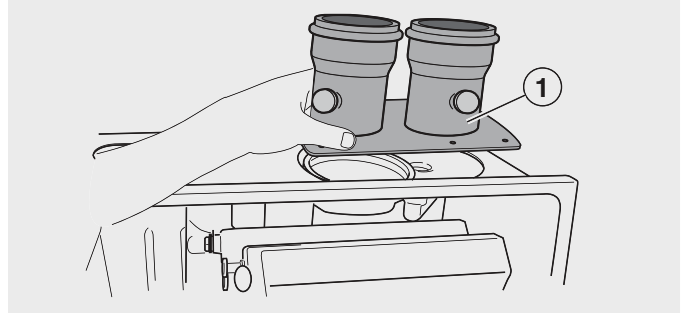

- Remove the heat exchanger by pulling forward on the bottom end and then pushing it upwards [Fig.13].

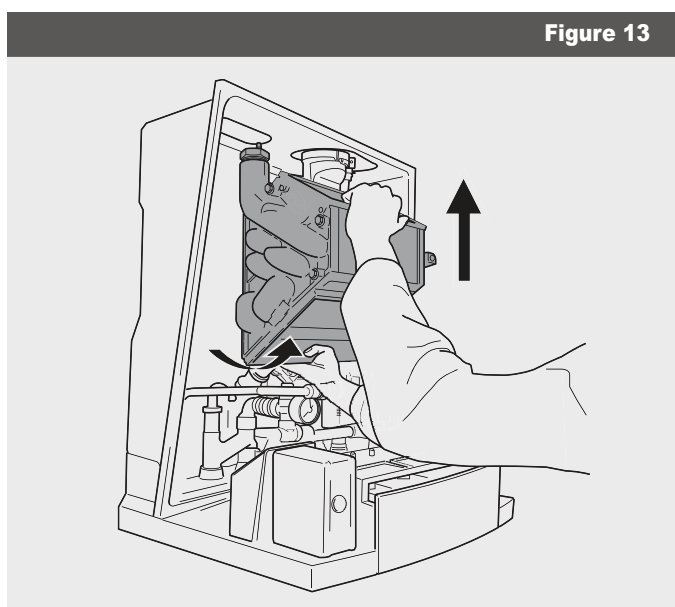

- Remove the flue gas collector from the old heat exchanger, including the oval seal.
- Put silicon on both sides of the new oval seal [Fig.14, pos.2], the flue gas collector and the new heat exchanger [Fig.14, pos.1].

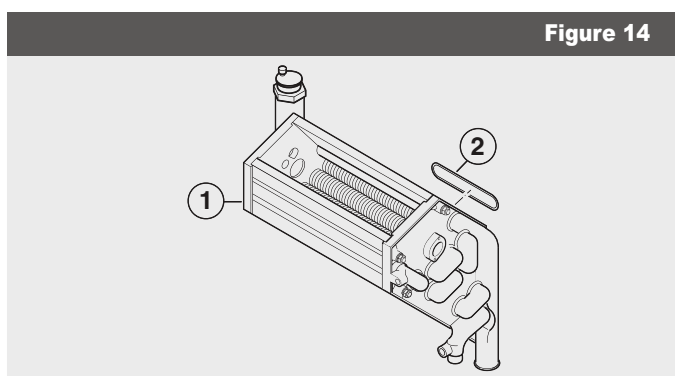

- Reassemble the flue gas collector with the new oval seal to the new heat exchanger.
- Check if the new oval seal is placed correctly by opening the condensate collector.

- Install the new seal for the condensate collector [Fig.15, pos.2].

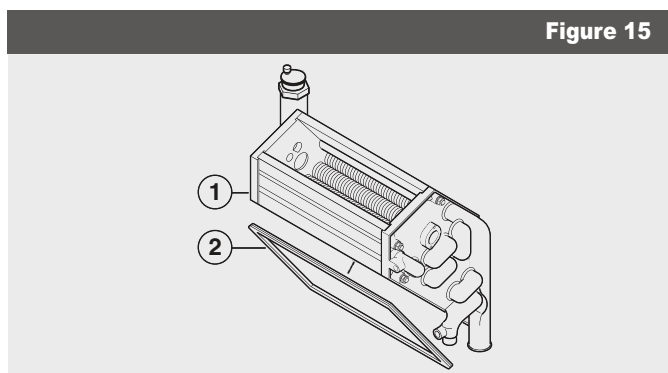

- Install the new heat exchanger and all other parts in reverse order of disassembly.



# BOSCH

Bosch Thermotechnology Corp.  
 65 Grove Street  
 Watertown, MA 02472  
 Tel: (866) 642-3198  
 Fax: (603) 965-7581  
[www.bosch-thermotechnology.us](http://www.bosch-thermotechnology.us)