

Technical Service Bulletin:

IDS Family Outdoor Models – Correct Fan Motor Removal Procedure

The information contained in this bulletin applies to all outdoor IDS models.



BOSCH



WARNING

Dangerous operation, injury or property damage!

Improper servicing could result in dangerous operation, injury or property damage. The operations described below must be performed by qualified personnel.

Fan motor replacement requires ensuring that you follow the correct procedure to separate the fan motor from the top grille. Failure to do so could result in damage to one or more components.

This work must only be conducted by a qualified contractor who is familiar with working on HVAC equipment.

1. Ensure that power to the product has been turned off at the installer-supplied local disconnect switch or at the appropriate circuit breaker.
2. Gently pry off the logo plastic center cap (see Fig.1);

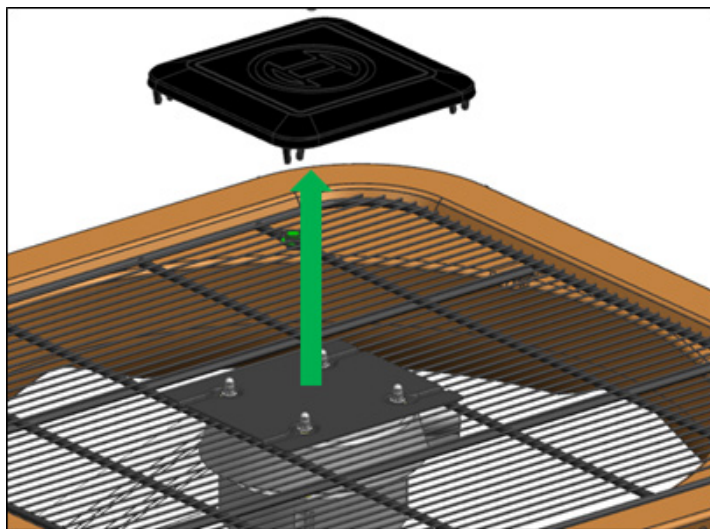

Fig.1

3. Work your way around the edge of the fan grille and remove all screws that are holding it in place (see Fig.2). Please note that the quantity of screws and the grille shape may vary from model to model;

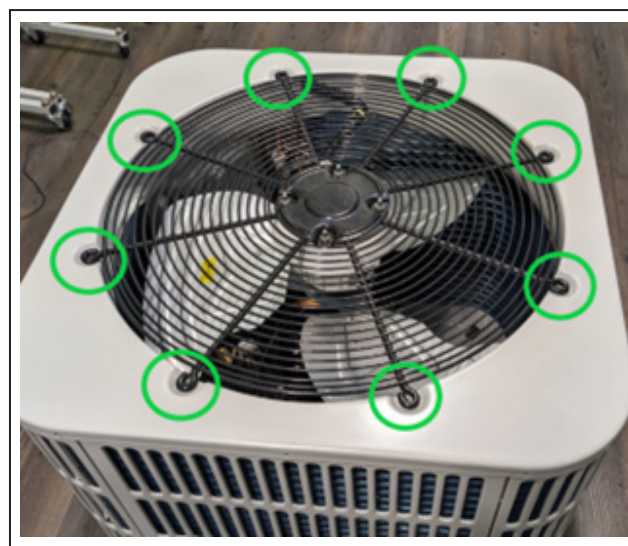

Fig.2

4. Carefully flip over the now unsecured fan assembly to access the motor wiring. It is hard-wired into the motor and runs through a hole in the chassis to plug into the PCB. Remove any zip ties you find that secure the wiring to the grille (see Fig.3);

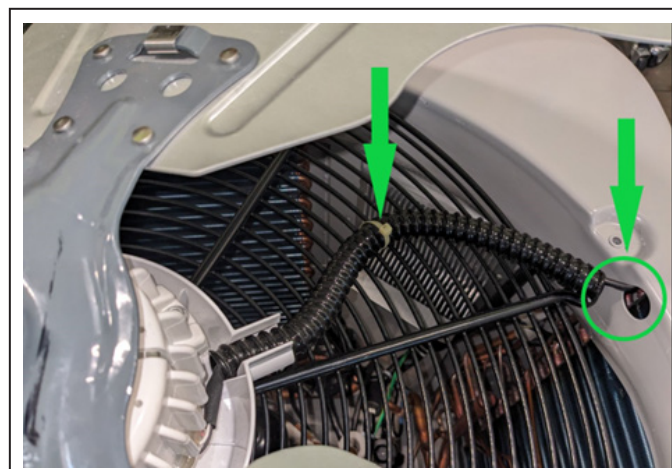

Fig.3

5. Remove the PCB access panel, and remove all zip ties that bundle the fan wiring together with other wiring.

The fan wires are bundled through the hole in the chassis in the upper-left area circled below, and are plugged in at the PCB connector also shown below (see Fig.4). Unplug the connector and carefully fish the fan wiring and connector up through the chassis hole and back to the removed fan;

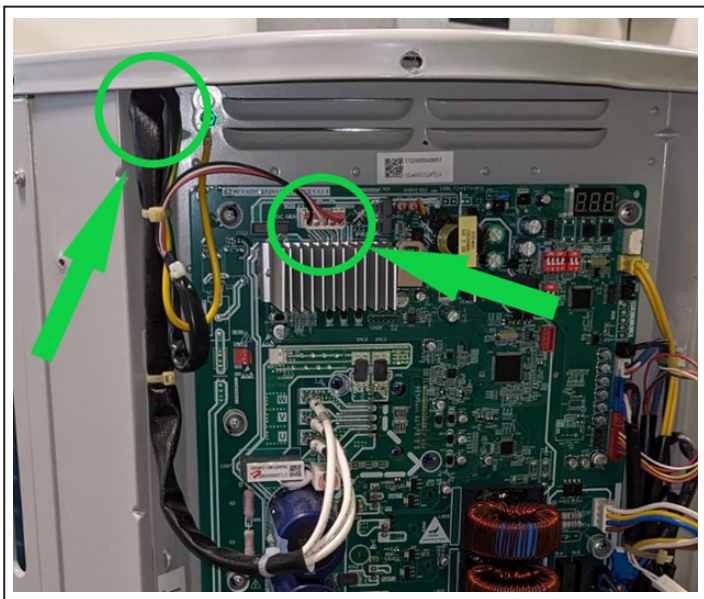

Fig.4

6. The fan assembly is held on to the grille by four nuts (Fig.5). Remove them while making sure that the assembly doesn't fall free when the nuts are removed;

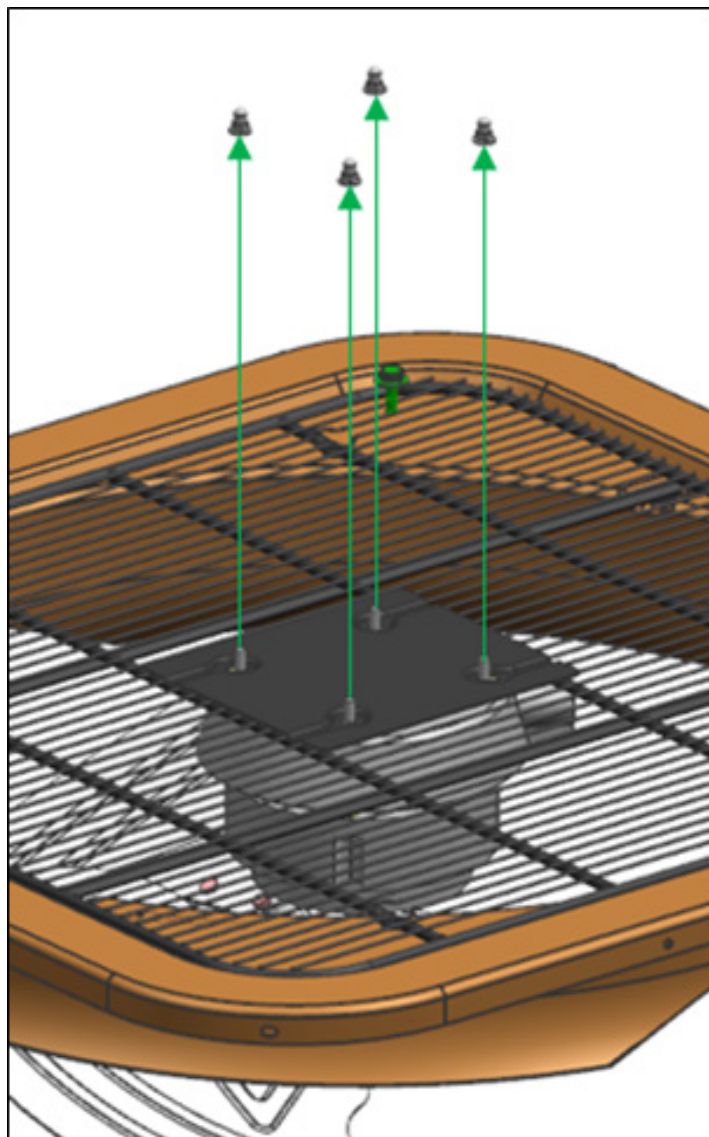

Fig.5

7. To remove the fan blades from the motor, begin by removing the four long bolts shown below (Fig.6) and lifting up the motor cover;

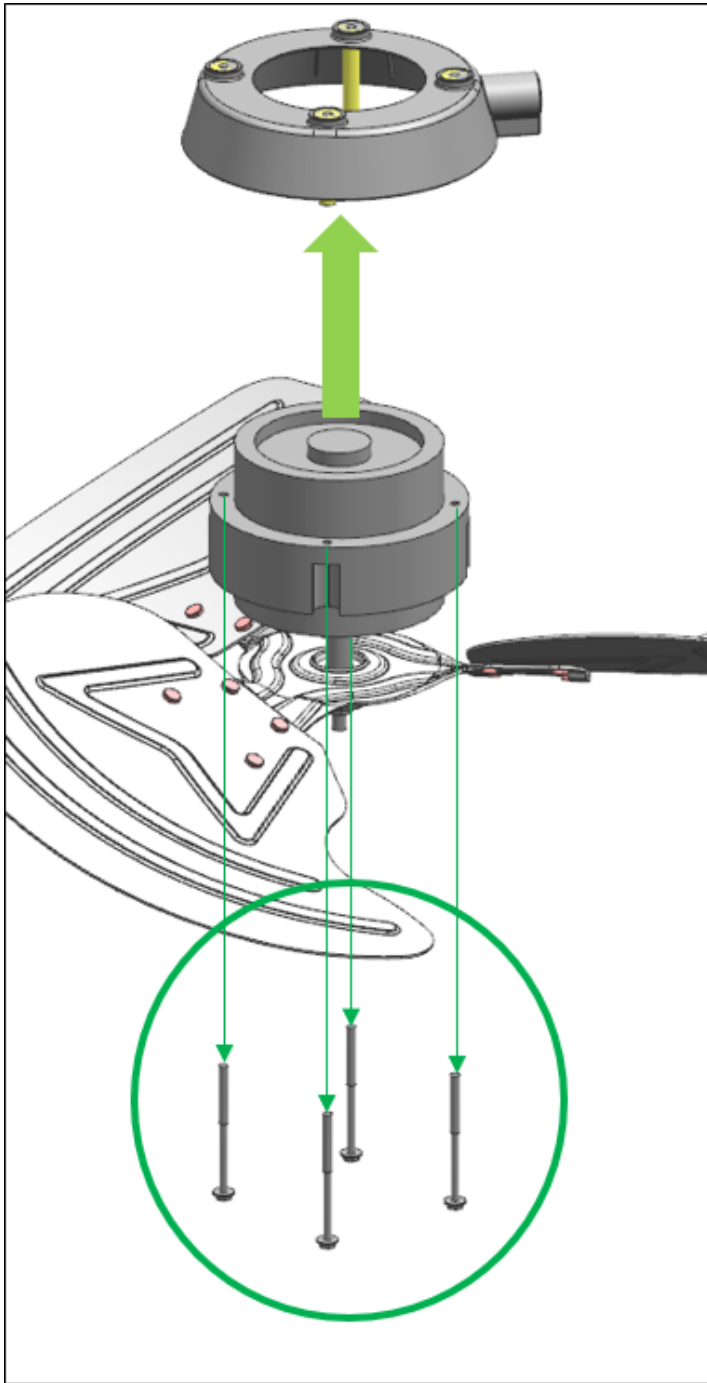

Fig.6

8. Remove the nut (1) and the screw (2) to release the fan blades from the motor shaft (Fig.7);

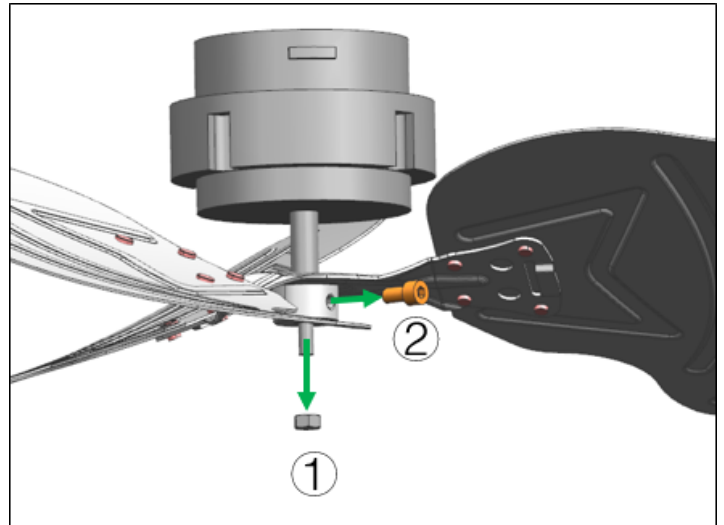

Fig.7

9. Finally, remove the blade assembly from the motor shaft (Fig.8). The motor removal is now complete;

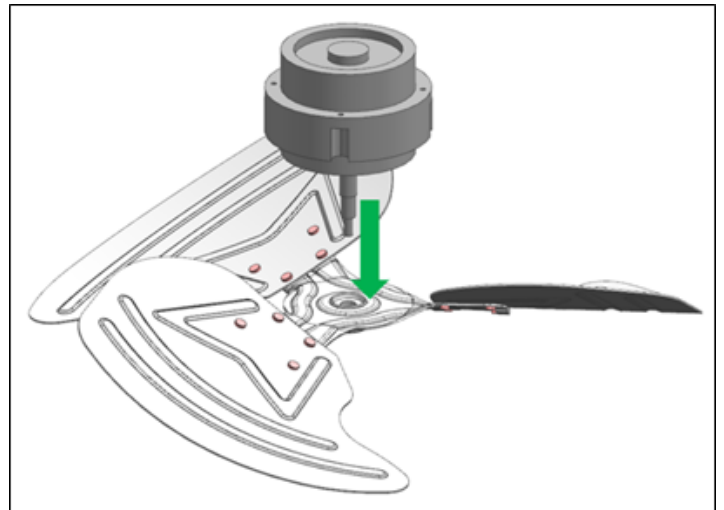

Fig.8

10. Reassembly is achieved by following the above steps in reverse order.



If you have any questions regarding the information provided in this document, please contact our Technical Support team by phone at 1-800-283 3787, or via email at ac.techsupport@us.bosch.com.



BOSCH

Bosch Thermotechnology Corp.
65 Grove Street
Watertown, MA 02472
Tel: 1-800-283-3787
www.bosch-homecomfort.us